

## **APPENDIX I**

### **Minimum Standards for Vehicle Access Design**

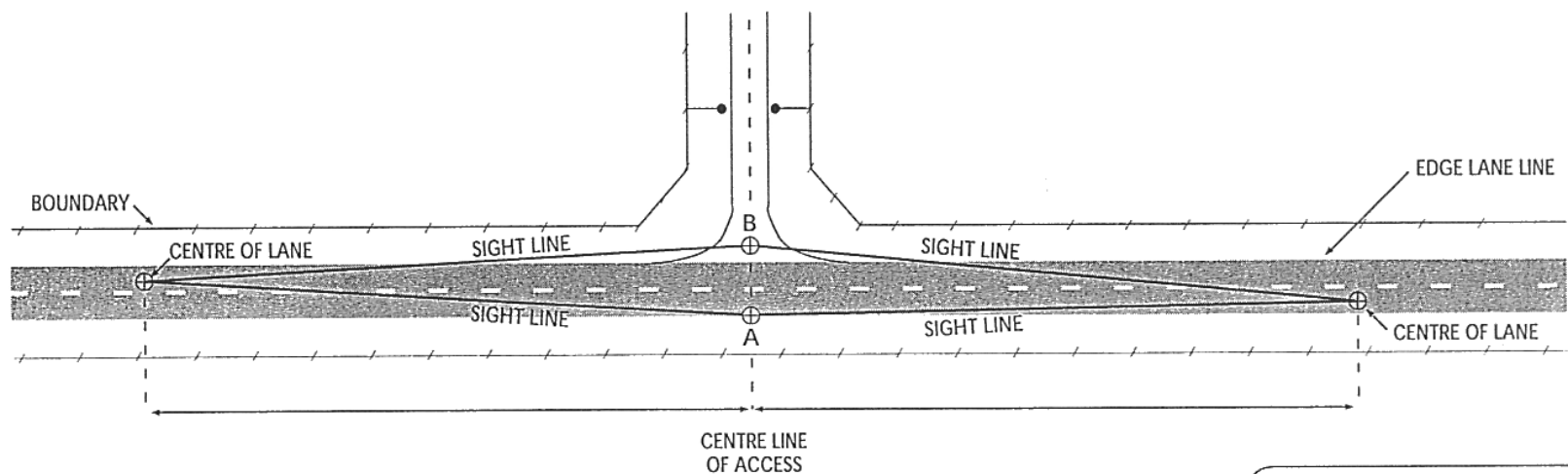

**POINT A** On white line

**POINT B** *For low use accesses*  
3.5 metres from white edge lane line  
*For moderate use accesses*  
5.5 metres from white edge lane line

#### NOTES

- Sight distances shall be measured 1.15 metres (motorists eye level) above the finished surface of the access crossing place and the highway
- There shall be no obstructions to visibility inside the area bounded by the sight lines

#### SIGHT DISTANCES (metres)

SPEED LIMIT	LOW USE ACCESS	MODERATE USE ACCESS
50	65	85
60	85	115
70	115	140
80	140	170
90	170	210
100	210	250

SPEED LIMIT	DISTANCES (metres)		
	K	M	N
50	30	20	15
60	50	30	20
70	100	45	40
80	120	60	100
90	150	60	150
100	200	60	200

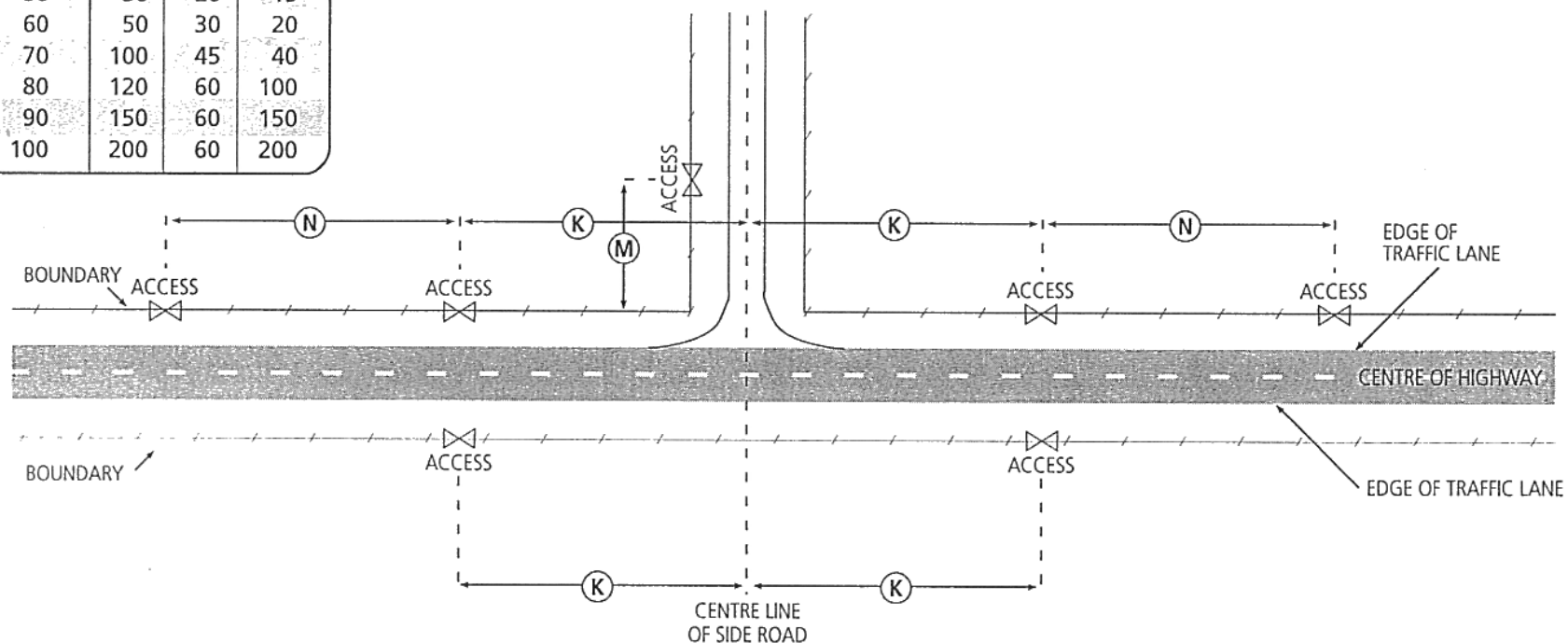

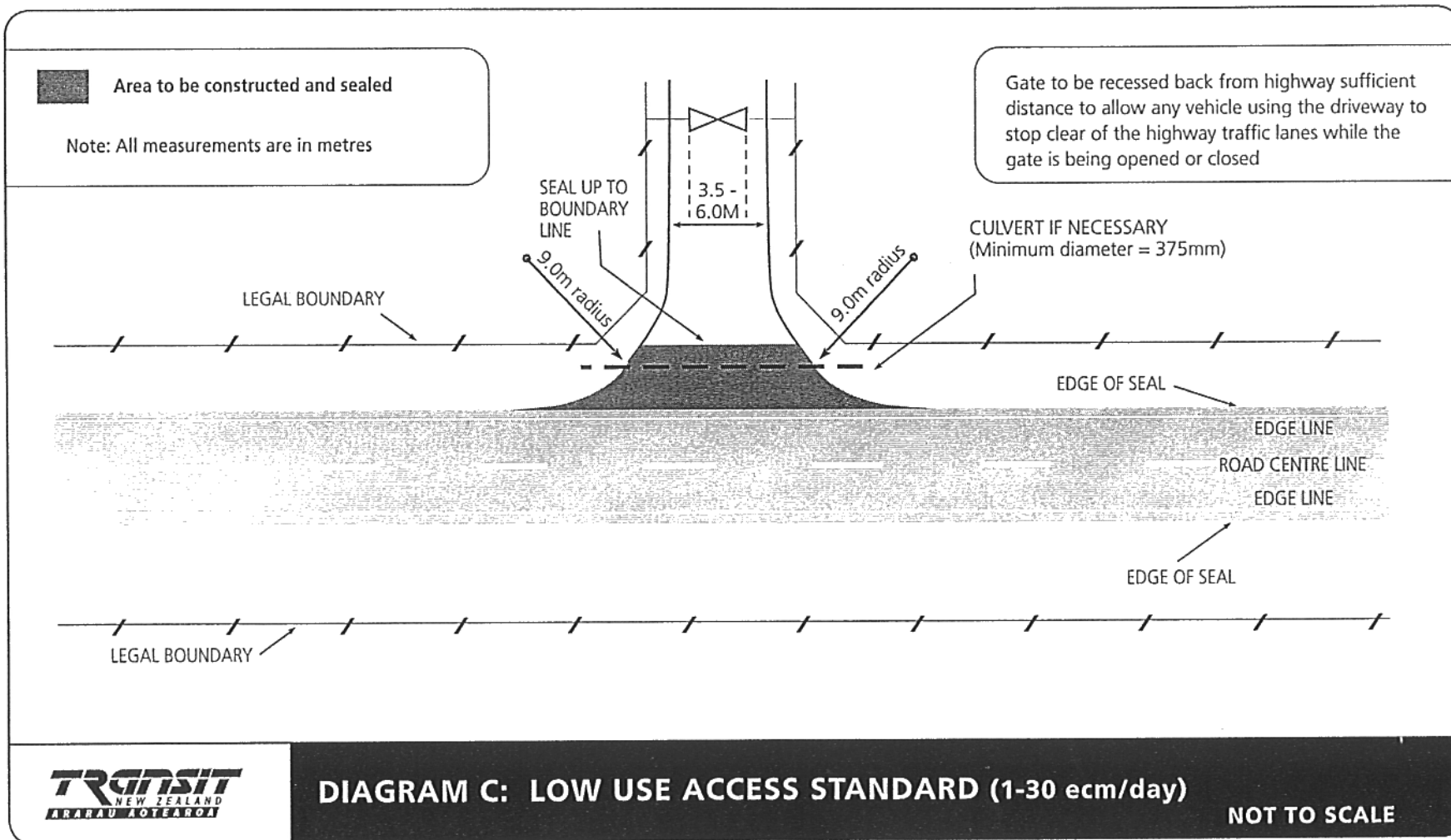

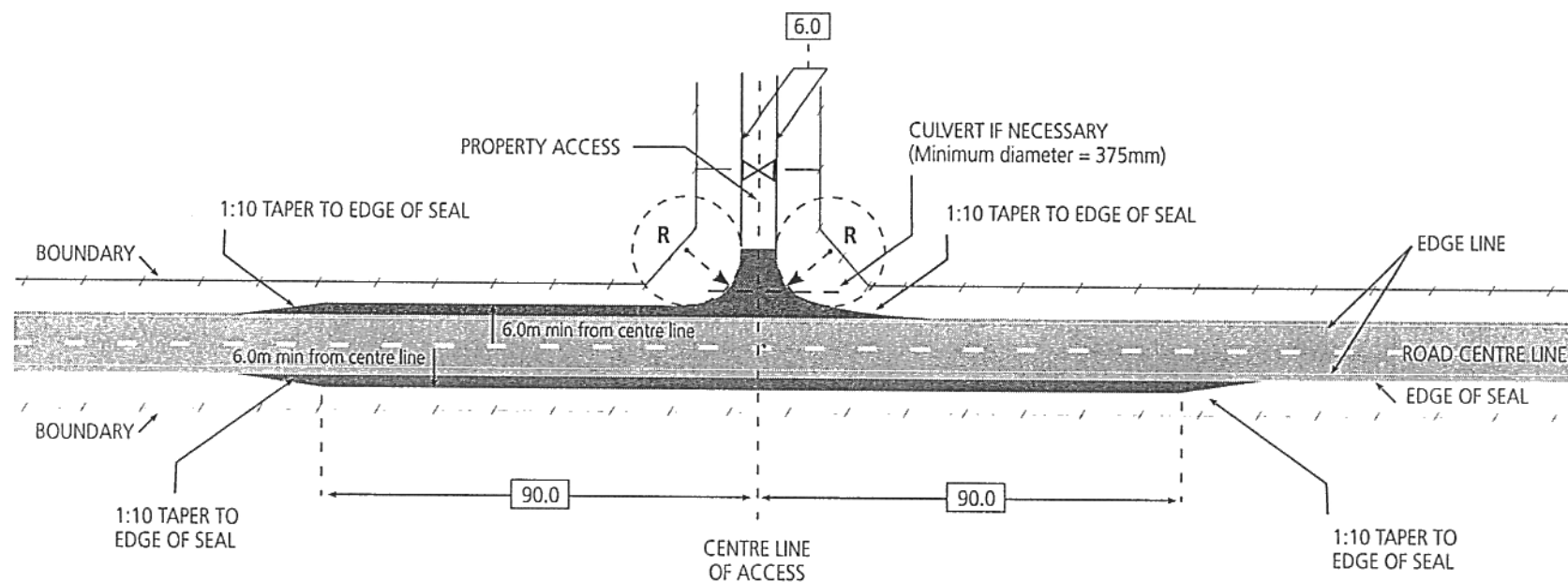

**Bellmouth Radii (R)**

- R = 9.0m Light vehicle use (eg road side stalls)
- R = 15.0m Heavy vehicle use (eg tourist attractions and heavy vehicle land uses)



Area to be constructed and sealed

Note: All measurements are in metres

Gate to be recessed back from highway sufficient distance to allow any vehicle using the driveway to stop clear of the highway traffic lanes while the gate is being opened or closed



Seal widening and access sealing

Note: All measurements are in metres

Gate to be recessed back from highway sufficient distance to allow any vehicle using the driveway to stop clear of the highway traffic lanes while the gate is being opened or closed

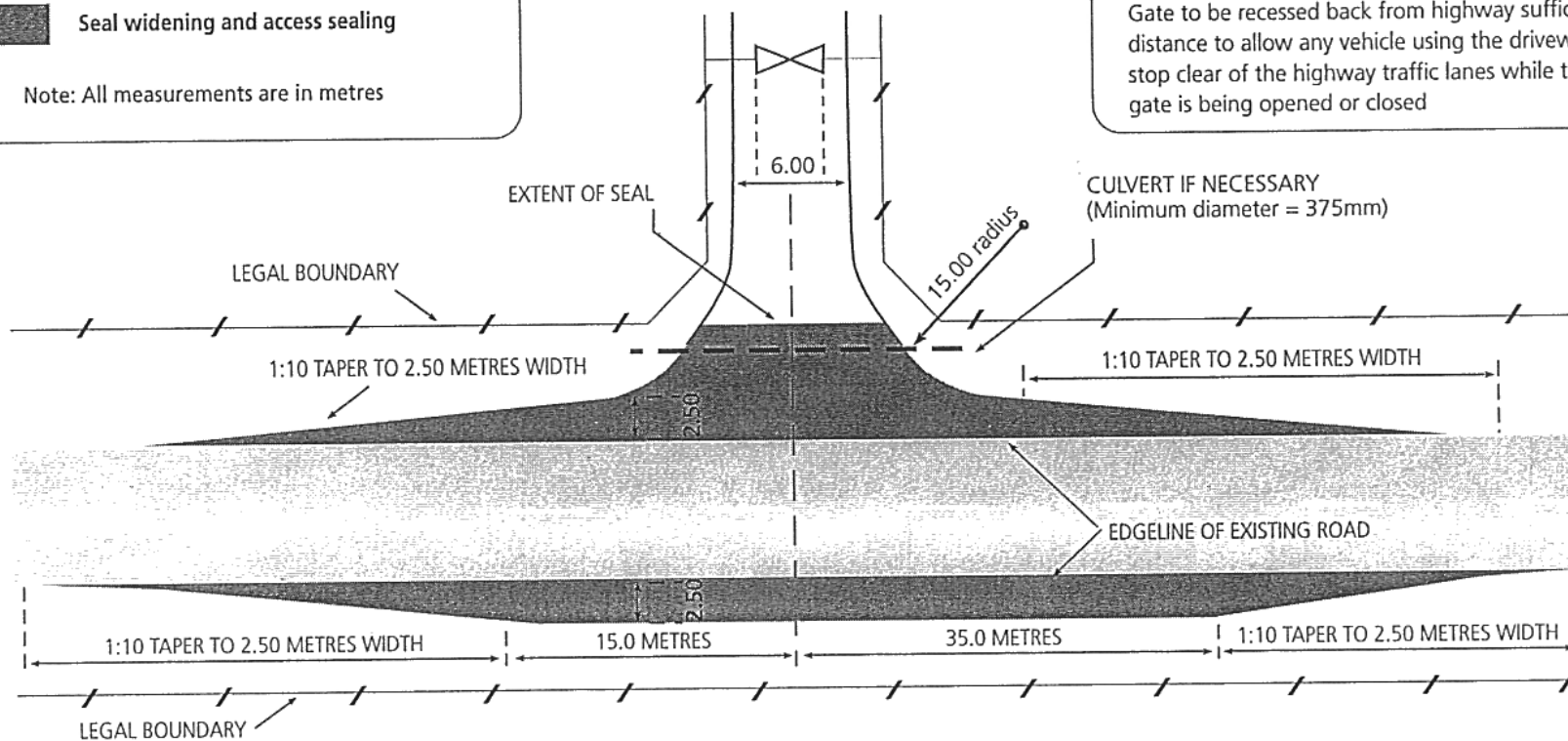

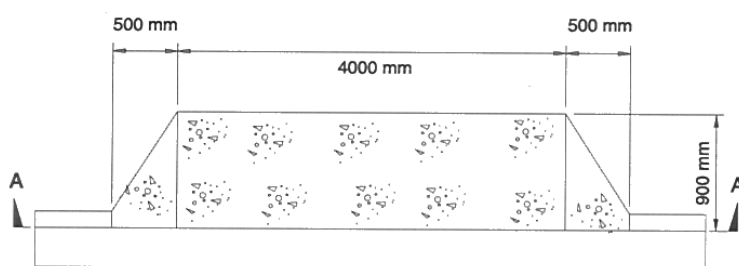

**PLAN OF VEHICLE DISH CROSSING**

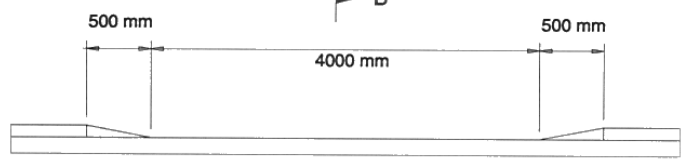

**SECTION A-A**

**NOTE:**

- FOR COMMERCIAL CROSSINGS
- APRON THICKNESS 150mm
- D12 REINFORCING BAR AT 250mm CENTRES BOTH WAYS OR 644 HRC MESH
- REINFORCING 50mm COVER FROM BASE
- MINIMUM CONCRETE COMPRESSIVE STRENGTH TO BE 20MPa AT 25 DAYS

**NOTE: NO LIP CROSSING REQUIRED:**

- IN CENTRAL BUSINESS DISTRICT. (C.B.D.)
- IN SUBURBAN SHOPPING PRECINCTS OR OTHER HIGH PEDESTRIAN TRAFFIC AREAS
- WHERE CHANNEL GRADIENT IS SUFFICIENT TO PREVENT SILTING OF THE CROSSING INVERT.

**4 m Wide Residential Crossing**

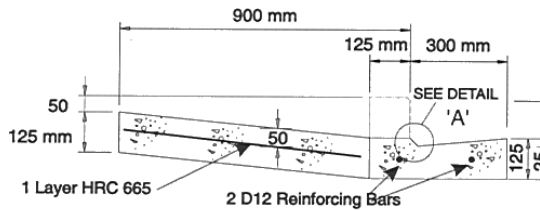

**SECTION B-B STANDARD CROSSING**

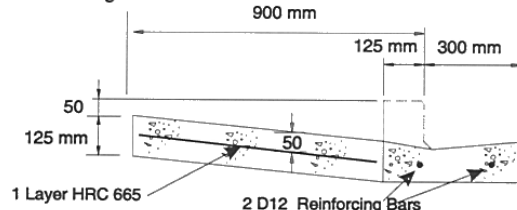

**SECTION B-B NO LIP CROSSING**

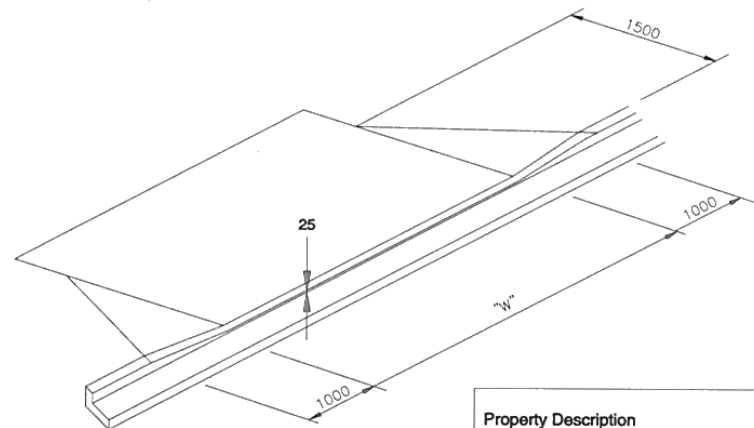

**MINIMUM STANDARDS FOR VEHICLE CROSSINGS ONTO URBAN ROADS**

ANGLE OF KERB AT 45° FOR WHEELCHAIR ACCESS

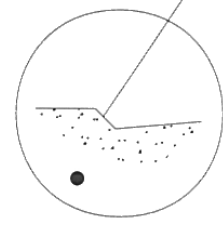

**DETAIL 'A'**

Property Description	Width "W"	Concrete Depth "D"	HRC Reinforcing Mesh
Residential 1-3 Dwellings	3 m	100 mm	1 Layer 665
4-6 Dwellings	4 m	125 mm	
7+ Dwellings	6 m	150 mm	
Light Commercial (not requiring specific design)	4 m	150 mm	
Industrial (not requiring specific design)	6 m	150 mm	

**NOT TO SCALE**



**WAIROA DISTRICT COUNCIL**

**VEHICLE ACCESS CROSSINGS**

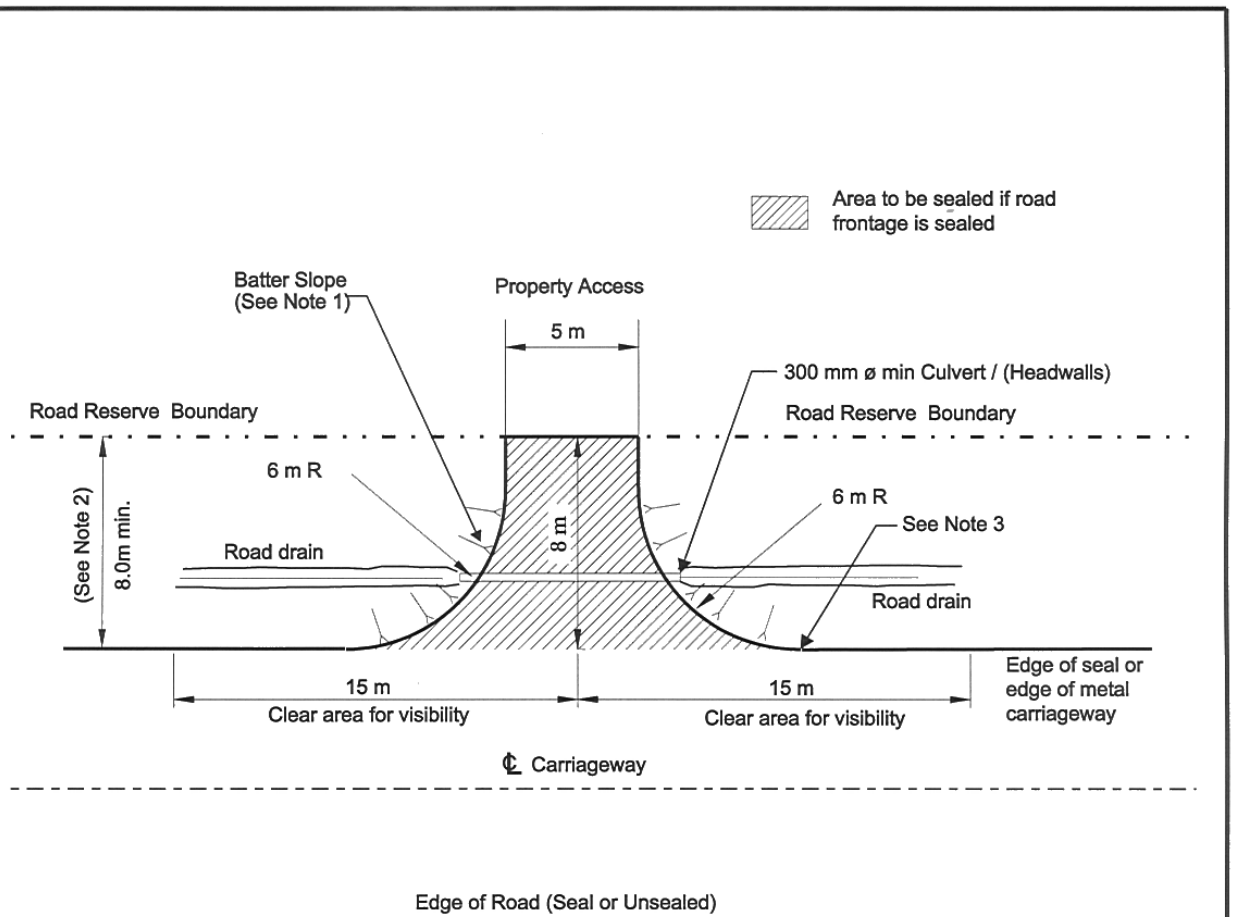

### NOTES:

- 1.) Batter slopes not to be steeper than 1.5H : 1.0V
- 2.) The Basecourse metal formation is to extend at least 100 mm further than the final seal area
- 3.) If the road boundary fence is less than 8m from the edge of seal, the fence is to be repositioned outside the area required for road user visibility, and the gate shall be positioned a minimum of 8m from the edge of the road seal

NOT TO SCALE



WAIROA DISTRICT COUNCIL

MINIMUM VEHICLE CROSSING FOR A  
SINGLE RURAL RESIDENTIAL PROPERTY



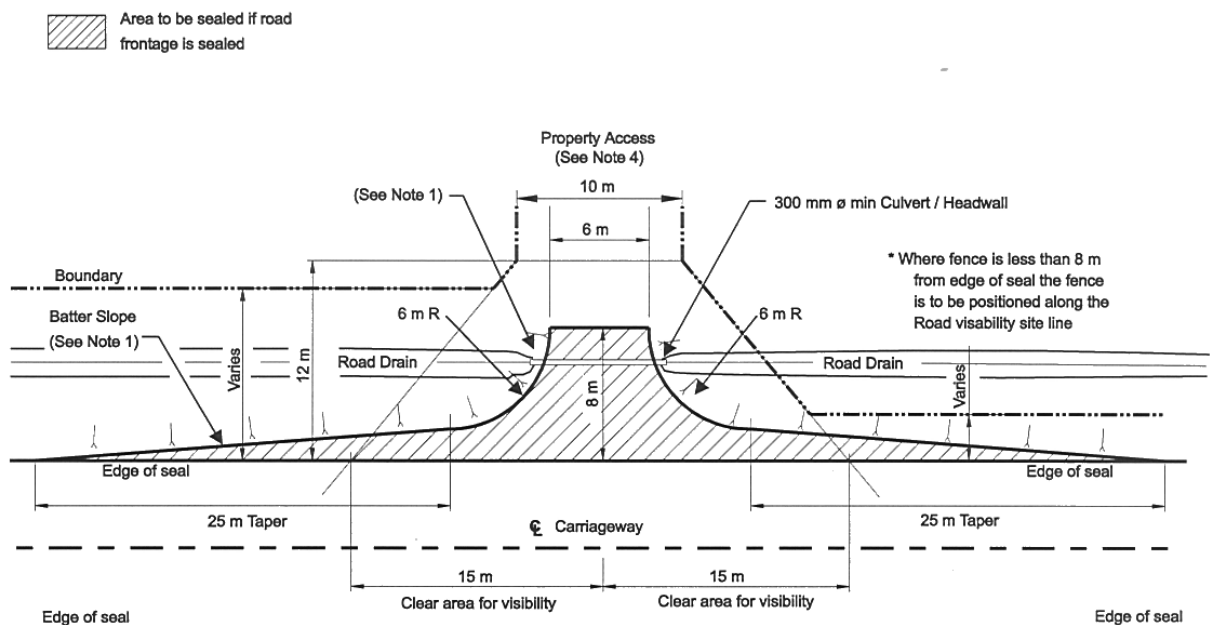

### NOTES:

- 1.) Batter slopes are not to be any steeper than 1.5H : 1.0V
- 2.) The Basecourse metal formation is to extend at least 100 mm further than the final seal area
- 3.) If the road boundary fence is less than 8 m from the edge of seal, the fence is to be repositioned outside the area required for road user visibility, and the gate shall be positioned a minimum of 8 m from the edge of the road seal
- 4.) The Gate shall be situated no less than 12 m from the road seal edge
- 5.) If the rural road is unsealed, the detail above will still apply except that sealing of the accessway is optional

NOT TO SCALE



WAIROA DISTRICT COUNCIL

MINIMUM VEHICLE CROSSING FOR MULTIPLE RURAL  
RESIDENTIAL PROPERTIES ,FARMING & FORESTRY ACTIVITIES