

AREA D: THE ENTRANCE

The curved walls that mark the entrance are built of stone from near Whakapunake. Two pou flank the sides and represent contemporary sculptural interpretations of 2 of the 6 pilot hill flagstaff encoded messages. Timber, copper and rope will form materials for the pou (to be designed by local Maori), which form a link with maritime themes associated with the site.

AREA A1: GARDEN OF LOST BOTANY

To celebrate the former garden that was known to have been present on the top flat terrace in the early Rangihoua pa site, it is proposed to plant the area surrounding this clearing with native plants that are now rare in this area and would have once been abundant. At each end of this northern of the two clearings, there is a raised platform area with seating for people to enjoy the stunning views. The clearings will be surrounded by round smooth limestone boulders.



SITE PLAN OF RANGI-HOUA
DO NOT SCALE

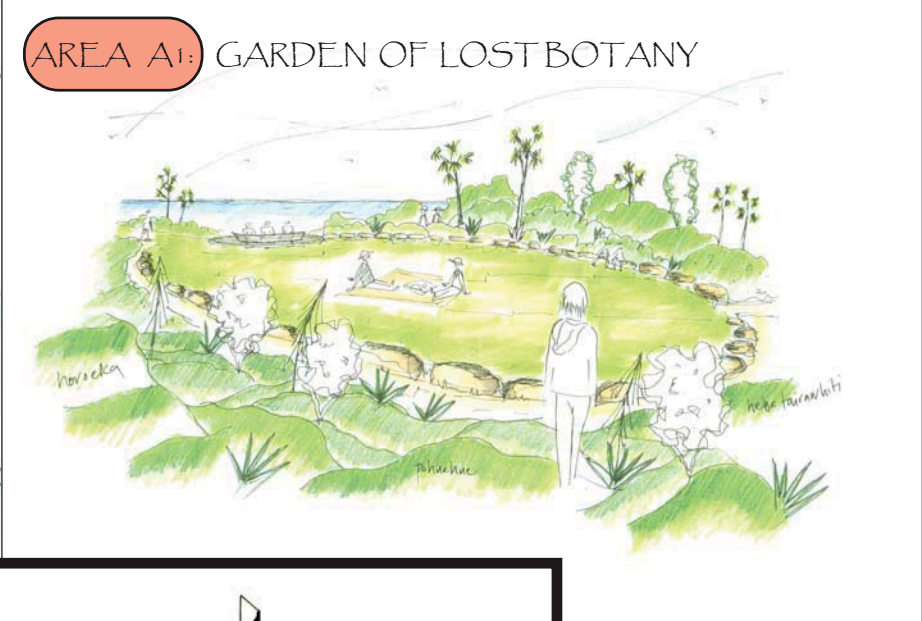

AREA A2: LOOKOUT & SHELTER

This area lies to the south of Rangihoua and enjoys outstanding views over the mouth of the Wairoa River and the ocean. A small curved shelter nestles next to a young pohutukawa and provides seating and shade for walkers. Interpretive panels regarding the history of the site flank the walls at the back. Another of the 6 pou arises through the centre of the shelter.

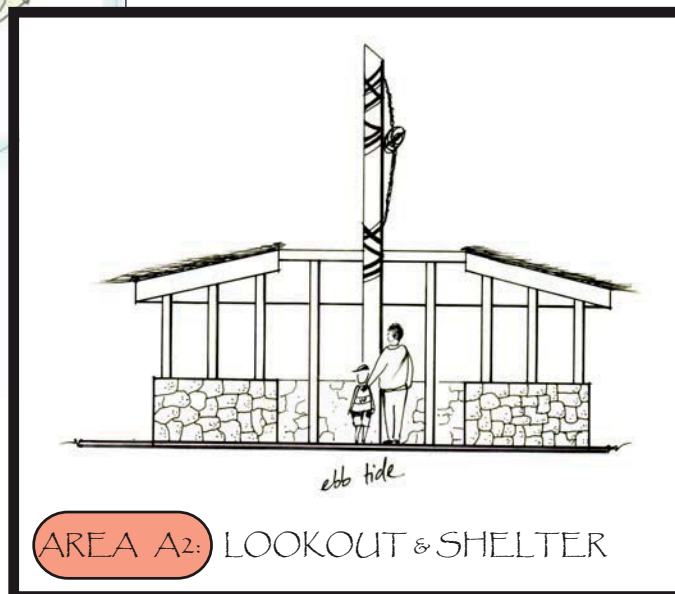

AREA A2: LOOKOUT & SHELTER



RANGI-HOUA/PILOT HILL LANDSCAPE DEVELOPMENT CONCEPT

prepared for the WAIROA DISTRICT COUNCIL
by EASTERN EARTH LANDSCAPE ARCHITECTS march 2010

